

PROJECT:

OPERATIONAL WORKS
CIVIL ENGINEERING

PROJECT DETAILS:

'ARCHERS WAY' ESTATE - STAGE 3
AT 22-80 CASH STREET, D'AGUILAR

PROJECT NUMBER: M2584E_3
MORETON BAY REGIONAL COUNCIL
REFERENCE: DA/38032/2019/V3RL

27 ALLOTMENTS
LOT1 ON RP230991 &
LOT2 ON RP80309
AREA - 2.529 ha

LOCALITY PLAN



N.T.S.

SAFETY IN DESIGN

THE ENGINEERING DESIGN FOR THE PROPOSAL HAS BEEN DEVELOPED TO MEET THE STATED PROJECT BRIEF, AS EXPRESSED IN JFP URBAN CONSULTANTS OFFER FOR THE WORKS, AND THE DESIGN STANDARDS STIPULATED BY THE LOCAL AUTHORITY NAMED ON THIS PLAN. IT IS EXPECTED THAT A COMPETENT PRINCIPAL CONTRACTOR WILL BE APPOINTED FOR THE PROJECT AND THAT ALL 'HIGH RISK' CONSTRUCTION WORKS WILL BE ADDRESSED AS PART OF THEIR PROJECT SAFETY PLAN FOR THE SITE.

NON-STANDARD DESIGN SOLUTIONS ADOPTED IN THE PREPARATION OF THE PROPOSAL ARE LISTED AS FOLLOWS;

A HAZARD ASSESSMENT OF THESE NON-STANDARD ITEMS HAS BEEN CONDUCTED AND THE FOLLOWING HAZARDS, THEIR ASSOCIATED RISKS AND THE CONTROL MEASURES SUGGESTED ARE LISTED BELOW;

NON-STANDARD DESIGN ITEM	HAZARD IDENTIFIED	RISK ASSESSMENT	CONTROL MEASURE SUGGESTED
CONSTRUCTION OF WORKS WITHIN EXISTING ROAD RESERVE	POTENTIAL THREATS TO THE SAFETY OF THE PUBLIC USING THE EXISTING ROAD AND FOOTPATHS	MODERATE/POSSIBLE MAJOR RISK	PRINCIPAL CONTRACTOR TO INCLUDE TRAFFIC MANAGEMENT (INCLUDING PEDESTRIAN) FOR WORKS IN EXISTING ROAD RESERVE IN THEIR SAFETY PLAN

INDEX:

STAGING & SITE SURVEY PLANS

M2584E_3	L01	(B)	CONSTRUCTION STAGING PLAN
M2584E_3	L02	(B)	EXISTING SERVICES AND SITE SURVEY PLAN

EARTHWORKS PLANS

M2584E_3	EW01	(B)	EARTHWORKS LAYOUT PLAN
M2584E_3	EW02	(B)	EARTHWORKS LAYOUT DETAILS PLAN - SHEET 1 of 2
M2584E_3	EW03	(B)	EARTHWORKS LAYOUT DETAILS PLAN - SHEET 2 of 2
M2584E_3	EW04	A	EARTHWORKS DETAILS PLAN & NOTES

ROADWORKS PLANS

M2584E_3	R01	(B)	ROADWORKS LAYOUT PLAN
M2584E_3	R02	A	ROADWORKS NOTES AND DETAILS PLAN
M2584E_3	R03	(B)	ROADWORKS INTERSECTION DETAILS PLAN
M2584E_3	R04	A	ROADWORKS LONGITUDINAL SECTION - ROAD 3 (BRADMAN & FLINDERS STREET)
M2584E_3	R05	A	ROADWORKS CROSS SECTIONS - ROAD 3 (BRADMAN & FLINDERS STREET)
M2584E_3	R06	(B)	ROADWORKS LONGITUDINAL SECTION - ROAD 4 (BRADMAN STREET)
M2584E_3	R07	A	ROADWORKS CROSS SECTIONS - ROAD 4 (BRADMAN STREET)

SIGNS AND LINEMARKING PLANS

M2584E_3	SL01	(B)	SIGNS AND LINEMARKING PLAN
----------	------	-----	----------------------------

DRAINAGE PLANS

M2584E_3	D01	A	DRAINAGE CATCHMENT PLAN
M2584E_3	D02	(B)	DRAINAGE LAYOUT PLAN
M2584E_3	D03	(B)	DRAINAGE LONGITUDINAL SECTIONS - LINES F
M2584E_3	D04	A	DRAINAGE LONGITUDINAL SECTIONS - LINES L, 1A3L, 1A4L & 1B4L
M2584E_3	D05	A	DRAINAGE LONGITUDINAL SECTIONS - LINES J & 6J
M2584E_3	D06	A	DRAINAGE CALCULATION TABLE - SHEET 1 of 2
M2584E_3	D07	A	DRAINAGE CALCULATION TABLE - SHEET 2 of 2
M2584E_3	D08	A	DRAINAGE STRUCTURE DETAILS
M2584E_3	D09	(B)	DRAINAGE DETAILS - FAUNA CROSSING CULVERT

EROSION & SEDIMENT CONTROL PLANS

M2584E_3	ES01	A	EROSION AND SEDIMENT CONTROL LAYOUT - BULK EARTHWORKS PHASE
M2584E_3	ES02	A	EROSION AND SEDIMENT CONTROL LAYOUT - ROADS & DRAINAGE PHASE
M2584E_3	ES03	A	EROSION AND SEDIMENT CONTROL LAYOUT - PRACTICAL COMPLETION PHASE
M2584E_3	ES04	A	EROSION AND SEDIMENT CONTROL DETAILS
M2584E_3	ES05	A	EROSION AND SEDIMENT CONTROL DETAILS - SEDIMENT BASIN 1 - SHEET 1
M2584E_3	ES06	A	EROSION AND SEDIMENT CONTROL DETAILS - SEDIMENT BASIN 1 - SHEET 2
M2584E_3	ES07	A	EROSION AND SEDIMENT CONTROL DETAILS - SEDIMENT BASIN 2

SEWERAGE RETICULATION PLANS

M2584E_3	S01	(B)	SEWERAGE LAYOUT PLAN
M2584E_3	S02	(B)	SEWERAGE DETAIL LAYOUT PLAN - SHEET 1 of 2
M2584E_3	S03	(B)	SEWERAGE DETAIL LAYOUT PLAN - SHEET 2 of 2
M2584E_3	S04	A	SEWERAGE DETAILS PLAN
M2584E_3	S05	(B)	SEWERAGE NOTES PLAN
M2584E_3	S06	(B)	SEWERAGE LONGITUDINAL SECTIONS - LINE 1
M2584E_3	S07	A	SEWERAGE LONGITUDINAL SECTIONS - LINE 7, 10, 108, 109, 112 & 114

WATER RETICULATION PLANS

M2584E_3	W01	(B)	WATER RETICULATION LAYOUT PLAN - SHEET 1 of 2
M2584E_3	W02	(B)	WATER RETICULATION LAYOUT PLAN - SHEET 2 of 2
M2584E_3	W03	(B)	WATER RETICULATION DETAILS PLAN
M2584E_3	W04	A	WATER RETICULATION NOTES

JFOP

BRISBANE - SUNSHINE COAST - CENTRAL QLD

BRISBANE
JFP House - 76 Ernest Street,
South Brisbane Qld 4101
P 07 3012 0100 W www.jfp.com.au

JFP URBAN CONSULTANTS PTY. LTD. A.C.N. 050 414 045

PLANNERS

URBAN DESIGNERS

SURVEYORS

ENGINEERS

LANDSCAPE ARCHITECTS

PROJECT NUMBER

M2584E_3

FILE NAME: COVERSHEET.DWG

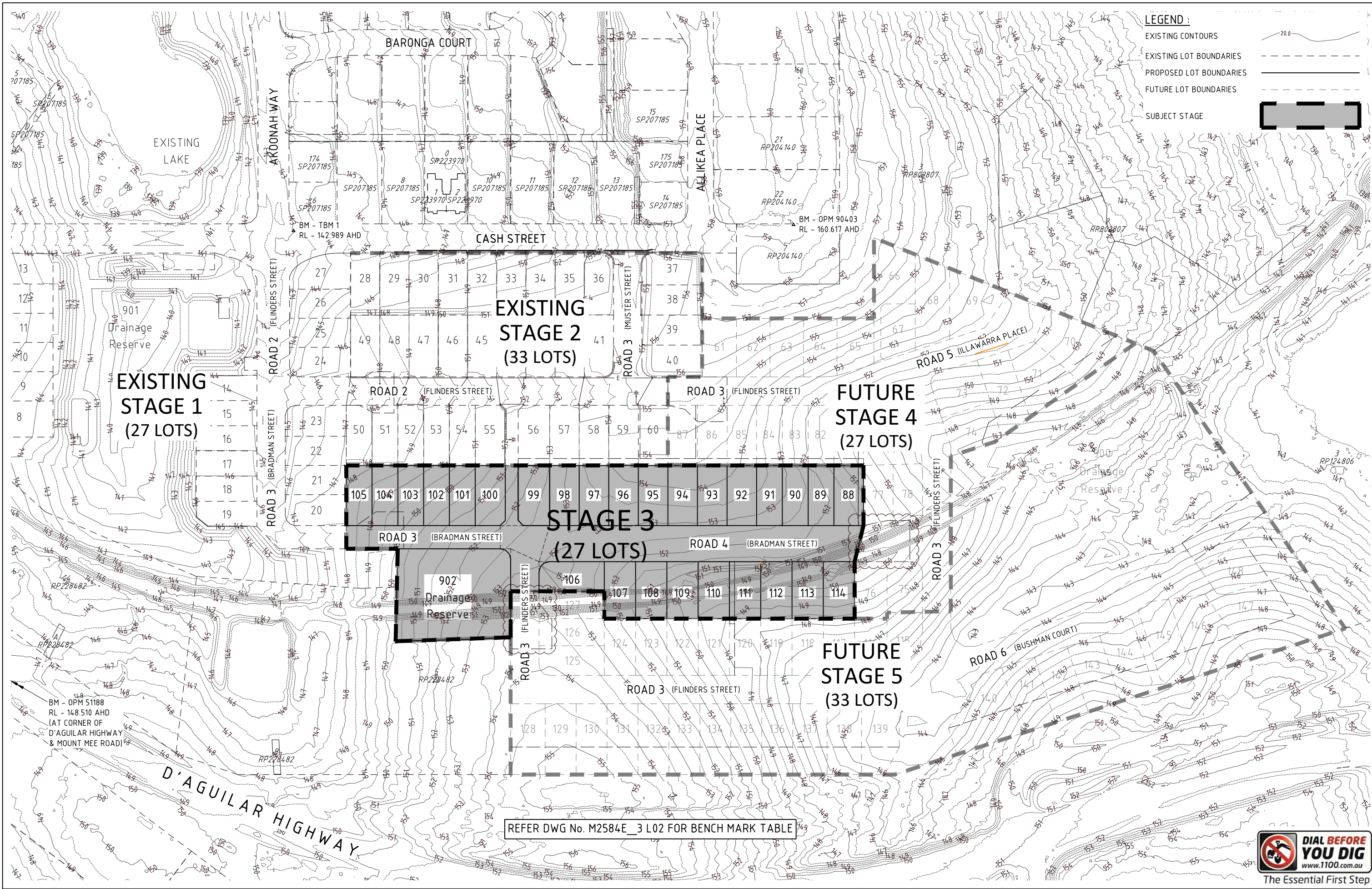

BRISBANE - SUNSHINE COAST - CENTRAL QLD
BRISBANE
JFP House - 76 Ernest Street,
South Brisbane Qld 4101
P 07 3012 0100 W www.jfp.com.au
JFP URBAN CONSULTANTS PTY. LTD. A.C.N. 050 414 045

PLANNERS
URBAN DESIGNERS
SURVEYORS
ENGINEERS
LANDSCAPE ARCHITECTS

NORTH:

SCALE:

1:1000

A1

THIS SCALE SHOWN IS ORIGINAL DRAWING SCALE

0 10 20 30 40 50 100 Metres

(A1) 1:1000 (A3) 1:2000

DO NOT SCALE FROM THIS DRAWING - USE ONLY DIMENSIONS PROVIDED - IF IN DOUBT PLEASE ENQUIRE

APPROVED	T. J. K.	DESIGNED	CDV
CHECKED	S. MARSH	DRAWN	WN
FOR AND ON BEHALF OF JFP URBAN CONSULTANTS PTY LTD	RPEQ 8068	DATE: AHD	DATE: AHD

ISSUE:

B

RFI AMENDMENTS
ISSUE FOR OPERATIONAL WORKS APPROVAL

DATE: 28/10/21
16/09/21

CDV
CDV
INIT:

TITLE:

CONSTRUCTION STAGING PLAN

DFC (PROJECT MANAGEMENT PTY LTD)

'ARCHERS WAY' ESTATE - STAGE 3
AT 22-80 CASH STREET, D'AGUILAR

DETAILS:

JOB NO:
M2584E_3

PLAN:
L01

ISSUE:
B

MORETON BAY REGIONAL COUNCIL REF:
DA/38032/2019/V3VR

FILE NAME: STAGING.DWG

DENNIS
FAMILY
CORPORATION

